



1 Martins Field , Trefonen, SY10 9EP

Town and Country are pleased to welcome to the rental market this 3 bedroom semi detached property on Martins Field in the desirable village of Trefonen! Comprising a modern kitchen and bathroom, three bedrooms, lounge and conservatory, this property makes a perfect family home. The private and enclosed rear garden provides a great space to relax and play. Trefonen has easy access to local amenities such as a primary school, shop, post office, village hall and the pub and only a 3 mile drive into Oswestry. Available from Early July.

£950

1 Martins Field

, Trefonen, SY10 9EP



- Three Bedroom Semi-Detached Home
- Driveway Parking
- Good Road Links
- Conservatory
- In the Village of Trefonen
- AVAILABLE EARLY JULY 2026
- Enclosed Rear Garden
- Close to the local Primary School

Directions

Accommodation Comprises:

Porch

Hall

Kitchen

Lounge

Conservatory

Landing

Bedroom One

Bathroom

Bedroom Two

Bedroom Three

Front Garden

Rear Garden

Additional Photograph

Services

Tenure/Council Tax

Town and Country Services

Hours Of Business

To Book a Viewing

Money Laundering Regulations

Additional Information

Tenant Information



[Directions](#)



Floor Plan

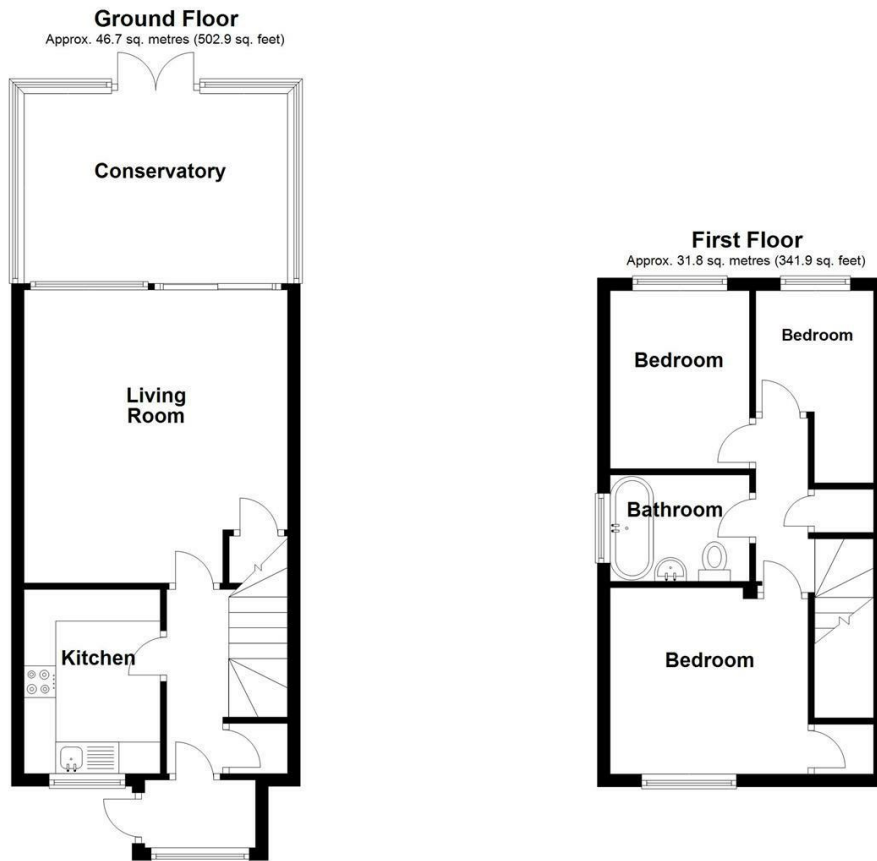

Total area: approx. 78.5 sq. metres (844.8 sq. feet)

These particulars, whilst believed to be accurate are set out as a general outline only for guidance and do not constitute any part of an offer or contract. Intending purchasers should not rely on them as statements of representation of fact, but must satisfy themselves by inspection or otherwise as to their accuracy. No person in this firm's employment has the authority to make or give any representation or warranty in respect of the property.

2-4 Willow Street, Oswestry, Shropshire, SY11 1AA
 Tel: 01691 679631 Email: SALES@TOWNANDCOUNTRYOSWESTRY.COM www.townandcountryestateagents.co.uk

Energy Efficiency Rating		Current	Potential
Very energy efficient - lower running costs			
(92 plus) A			90
(81-91) B			
(69-80) C			
(55-68) D		66	
(39-54) E			
(21-38) F			
(1-20) G			
Not energy efficient - higher running costs			
England & Wales		EU Directive 2002/91/EC	